

# Vinyl Tube



## APPLICATION

This specification applies to heat resistant corrugated tubes (hereinafter call " tube ") for use in protection and bundling of wire harness.

## FEATURES

Rate Temperature : 85°C

## TYPE AND DIMENSIONS

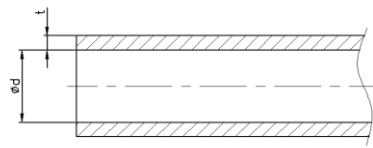
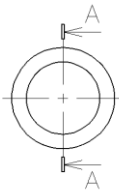

SECTION A-A



### Specification for Vinyl tube [ 80 °C ]

Material	Size	Inner Diameter (mm.)	Outer Diameter (mm.)	Thickness (mm.)	Size	Inner Diameter (mm.)	Outer Diameter (mm.)	Thickness (mm.)
PVC	3*4	Norminal :3.00	Norminal : 4.00	Norminal : 0.50	3*5	Norminal :3.00	Norminal : 5.00	Norminal : 1.00
	4*5	Norminal :4.00	Norminal : 5.00	Norminal : 0.50	4*6	Norminal :4.20	Norminal : 6.20	Norminal : 1.00
	5*6	Norminal :5.00	Norminal : 6.00	Norminal : 0.50	5*7	Norminal :5.00	Norminal : 7.00	Norminal : 1.00
	6*7	Norminal :6.00	Norminal : 7.00	Norminal : 0.50	6*8	Norminal :6.00	Norminal : 8.00	Norminal : 1.00
	7*8	Norminal :7.00	Norminal : 8.00	Norminal : 0.50	7*9	Norminal :7.00	Norminal : 9.00	Norminal : 1.00
	8*9	Norminal :8.00	Norminal : 9.00	Norminal : 0.50	8*10	Norminal :8.00	Norminal : 10.00	Norminal : 1.00
	9*10	Norminal :9.00	Norminal : 10.00	Norminal : 0.50	9*11	Norminal :9.00	Norminal : 11.00	Norminal : 1.00
	10*11	Norminal :10.00	Norminal : 11.00	Norminal : 0.50	10*12	Norminal :10.00	Norminal : 12.00	Norminal : 1.00
	11*12	Norminal :11.00	Norminal : 12.00	Norminal : 0.50	11*13	Norminal :11.00	Norminal : 13.00	Norminal : 1.00
	12*13	Norminal :12.00	Norminal : 13.00	Norminal : 0.50	12*14	Norminal :12.00	Norminal : 14.00	Norminal : 1.00
	13*14	Norminal :13.00	Norminal : 14.00	Norminal : 0.50	13*15	Norminal :13.00	Norminal : 15.00	Norminal : 1.00
	14*15	Norminal :14.00	Norminal : 15.00	Norminal : 0.50	14*16	Norminal :14.00	Norminal : 16.00	Norminal : 1.00
	15*16	Norminal :15.00	Norminal : 16.00	Norminal : 0.50	15*17	Norminal :15.00	Norminal : 17.00	Norminal : 1.00
	16*17	Norminal :16.00	Norminal : 17.00	Norminal : 0.50	16*18	Norminal :16.00	Norminal : 18.00	Norminal : 1.00
	17*18	Norminal :17.00	Norminal : 18.00	Norminal : 0.50	17*19	Norminal :17.00	Norminal : 19.00	Norminal : 1.00
	18*19	Norminal :18.00	Norminal : 19.00	Norminal : 0.50	18*20	Norminal :18.00	Norminal : 20.00	Norminal : 1.00
	19*20	Norminal :19.00	Norminal : 20.00	Norminal : 0.50	19*21	Norminal :19.00	Norminal : 21.00	Norminal : 1.00
	20*21	Norminal :20.00	Norminal : 21.00	Norminal : 0.50	20*22	Norminal :20.00	Norminal : 22.00	Norminal : 1.00
	21*22	Norminal :21.00	Norminal : 22.00	Norminal : 0.50	21*23	Norminal :21.00	Norminal : 23.00	Norminal : 1.00
	22*23	Norminal :22.00	Norminal : 23.00	Norminal : 0.50	22*24	Norminal :22.00	Norminal : 24.00	Norminal : 1.00
23*24	Norminal :23.00	Norminal : 24.00	Norminal : 0.50	23*25	Norminal :23.00	Norminal : 25.00	Norminal : 1.00	
24*25	Norminal :24.00	Norminal : 25.00	Norminal : 0.50	24*26	Norminal :24.00	Norminal : 26.00	Norminal : 1.00	
25*26	Norminal :25.00	Norminal : 26.00	Norminal : 0.50	25*27	Norminal :25.00	Norminal : 27.00	Norminal : 1.00	
26*27	Norminal :26.00	Norminal : 27.00	Norminal : 0.50	26*28	Norminal :26.00	Norminal : 28.00	Norminal : 1.00	
28*29	Norminal :28.00	Norminal : 29.00	Norminal : 0.50	28*30	Norminal :28.00	Norminal : 30.00	Norminal : 1.00	
30*31	Norminal :30.00	Norminal : 31.00	Norminal : 0.50	30*32	Norminal :30.00	Norminal : 32.00	Norminal : 1.00	
32*33	Norminal :32.00	Norminal : 33.00	Norminal : 0.50	32*34	Norminal :32.00	Norminal : 34.00	Norminal : 1.00	



Restriction of Hazardous Substances



Registration Evaluation and Authorization of Chemicals



Flameability Resistance



Chemical Resistance